

# TR9

english



TECHNOALPIN®

**TR9**

**TECHNO**





**TECHNOALPIN®**

## **TR9**

### **COMPACT EXCELLENCE.**

TechnoAlpin's development work has always focused on guaranteeing top quality snow whilst ensuring optimum use of resources, maximum user-friendliness and operational safety. To ensure optimum system efficiency, it is crucial to have the right snow gun in the right place at the right time. The TR family is now complete thanks to the TR9 fan gun, which has a smaller turbine.

[www.technoalpin.com](http://www.technoalpin.com) 

TECHNOALPIN®



# TR9

## BETTER PERFORMANCE WHEN IT REALLY COUNTS.

The TR9 boasts improved snowmaking performance with lower noise emissions and optimized energy balance compared to earlier models. The compressed air cooler and its generous dimensions are key in this respect. The optimally cooled compressed air improves nuclide formation and thus generates more snow particularly when it really matters – in the limit temperature range!

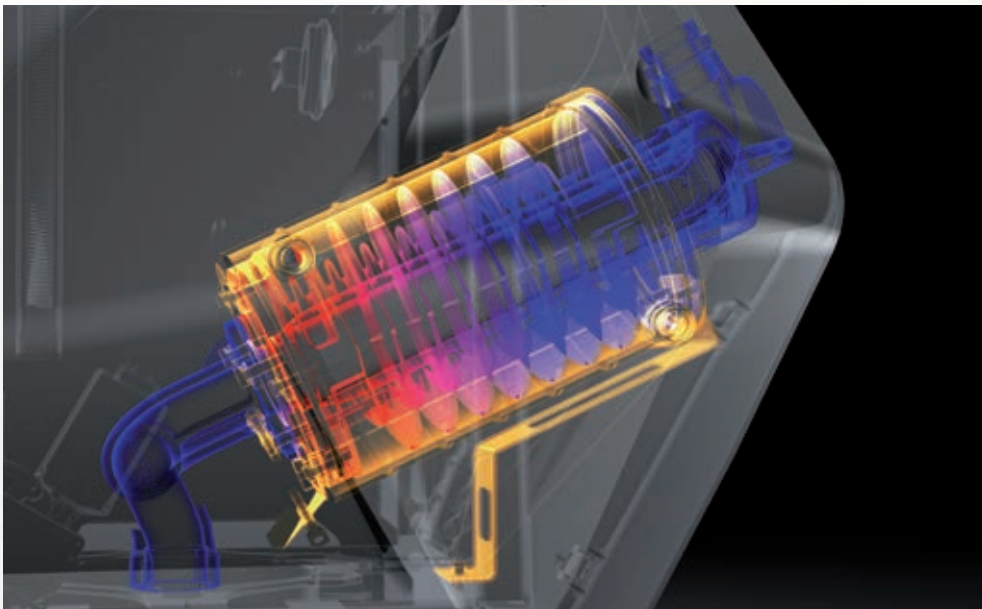

## FEWER RESOURCES BUT MORE QUALITY SNOW.

The TR9 is fitted with high-quality components as standard, thereby making the machine more efficient. The turbine and compressor are driven by just one electric motor. Thanks in particular to resource-saving nozzle valve technology and individually controllable valves, every drop of water is turned into snow. The nozzle valves are efficiently emptied using an ingenious system. The small amount of residual water inside the valve is fed directly into the air jet of the turbine by means of compressed air.



**TR9**

**TECHNOALPIN®**

## DOUBLE GEM QUALITY.

All machine nucleators have two ruby inserts as usual. However, the TR9 nozzles are now fitted with these ruby inserts as standard – for the very first time. The ruby inserts are characterized by maximum wear resistance even when faced with aggressive water and high operating pressures. They constantly generate high-quality snow over many years and significantly reduce wear and tear on the nucleators and nozzles.



**TR9**









## INTUITIVE. SAFE. USER-FRIENDLY.

The TR9 features automatic height adjustment and swinging function to facilitate the work of the snowmaking team. Thanks to the optimized design, all components are easily accessible and the device is easy to handle. The TR9 is also impressive because of its touch display – the biggest on the market.

# TR9

## TECHNICAL DATA

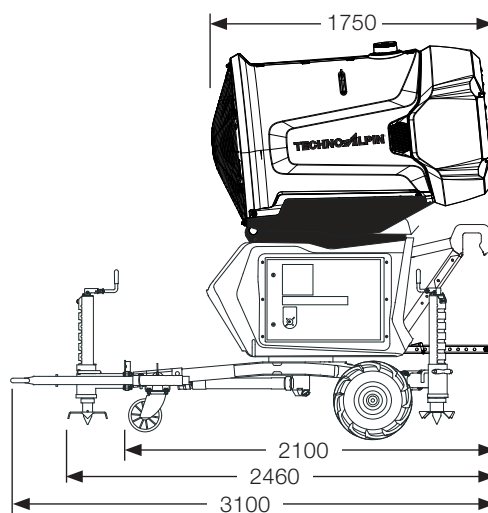
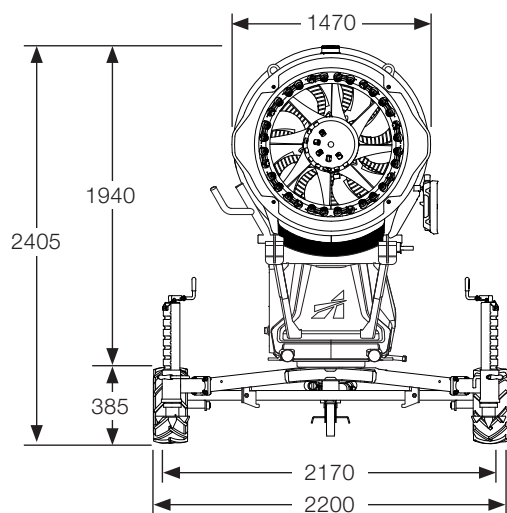

### Electrical properties

Nominal voltage	400 V
Nominal frequency	50 Hz
Nominal current	35 A*
Connection plug	5x63 A
Nominal power - POWER UNIT	
(turbine + compressor)	18.5 kW
Heating	1.0 kW

### Weights

Snow gun - compressor	652 kg
Transport frame with jacks	120 kg
Double lifting bracket	38 kg
KIT mobile undercarriage (CTGR0007)	62 kg

### Dimensions

Snow gun length	1,750 mm
Snow gun width	1,470 mm
Snow gun height	1,940 mm
Undercarriage height	385 mm
Total height	2,405 mm

Length [max.]	3,100 mm
Length [excluding draw bar]	2,460 mm
Length [excluding front jack]	2,100 mm
Track gauge [wheels]	2,200 mm
Width [excluding wheels]	2,170 mm

### Miscellaneous

Operating temperature	-25 ÷ +2° C
Rotational speed	1,500 rpm
Turbine inclination	45 deg.
Horizontal rotation	360 deg.
Swinging (automatic)	180 deg.

### Water

Operating water pressure	8 ÷ 40 bar
Water filter	250 micron
Water connection - Camlock	2"

### Nozzle configuration

Nucleator	6
Fixed Quadrijet nozzles	6
Switchable Quadrijet nozzles	12

\*Measurements at nominal voltage at 1500 m above sea level and at a temperature of 0°C.

Data are subject to change depending on system type and/or country of installation.



[WWW.TECHNOALPIN.COM](http://WWW.TECHNOALPIN.COM)