

# TR9

english US



**TECHNOALPIN®**

**TR9**

**TECHNOZ**





**TECHNOALPIN®**

## **TR9**

### **COMPACT EXCELLENCE.**

TechnoAlpin's development work has always focused on guaranteeing top quality snow whilst ensuring optimum use of resources, maximum user-friendliness and operational safety. To ensure optimum system efficiency, it is crucial to have the right snow gun in the right place at the right time. The TR family is now complete thanks to the TR9 fan gun, which has a smaller turbine.

[www.technoalpin.com](http://www.technoalpin.com) 

**TECHNOALPIN®**



# TR9

## BETTER PERFORMANCE WHEN IT REALLY COUNTS.

The TR9 boasts improved snowmaking performance with lower noise emissions and optimized energy balance compared to earlier models. The compressed air cooler and its generous dimensions are key in this respect. The optimally cooled compressed air improves nuclide formation and thus generates more snow particularly when it really matters – in the limit temperature range!

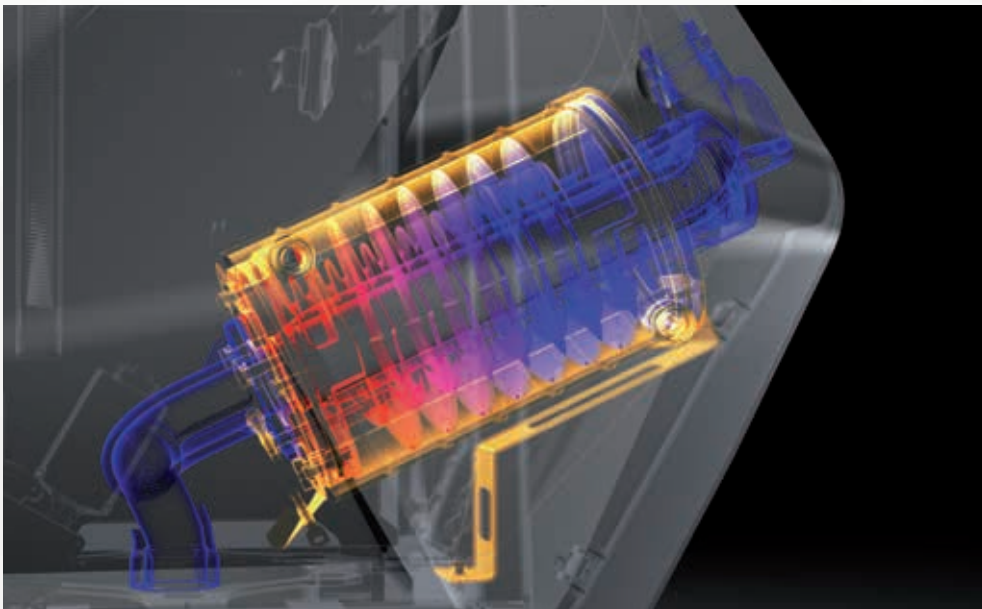

## FEWER RESOURCES BUT MORE QUALITY SNOW.

The TR9 is fitted with high-quality components as standard, thereby making the machine more efficient. The turbine and compressor are driven by just one electric motor. Thanks in particular to resource-saving nozzle valve technology and individually controllable valves, every drop of water is turned into snow. The nozzle valves are efficiently emptied using an ingenious system. The small amount of residual water inside the valve is fed directly into the air jet of the turbine by means of compressed air.



**TR9**

**TECHNOALPIN®**

## DOUBLE GEM QUALITY.

All machine nucleators have two ruby inserts as usual. However, the TR9 nozzles are now fitted with these ruby inserts as standard – for the very first time. The ruby inserts are characterized by maximum wear resistance even when faced with aggressive water and high operating pressures. They constantly generate high-quality snow over many years and significantly reduce wear and tear on the nucleators and nozzles.



**TR9**







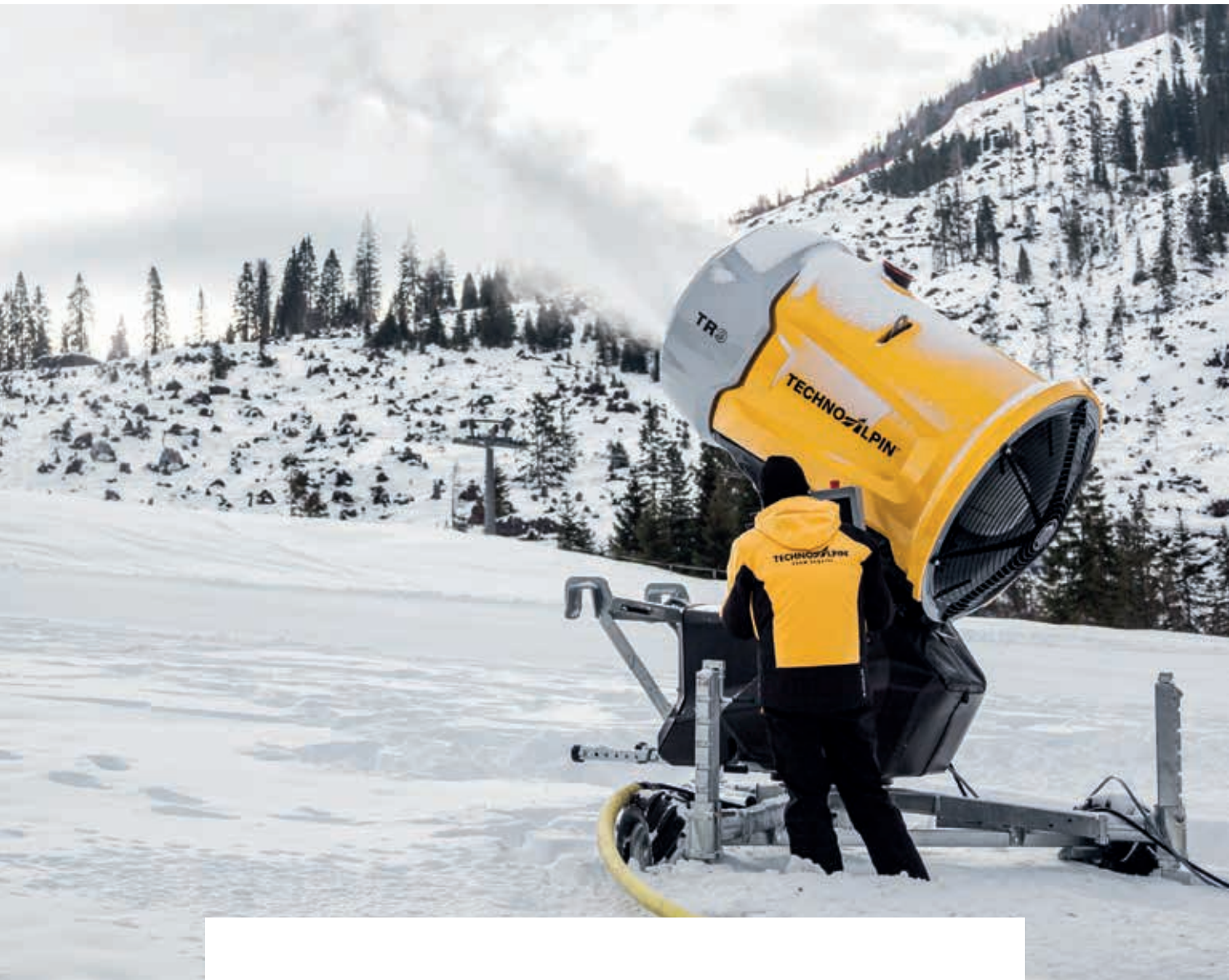

## INTUITIVE. SAFE. USER-FRIENDLY.

The TR9 features automatic height adjustment and swinging function to facilitate the work of the snowmaking team. Thanks to the optimized design, all components are easily accessible and the device is easy to handle. The TR9 is also impressive because of its touch display – the biggest on the market.

# TR9

## TECHNICAL DATA

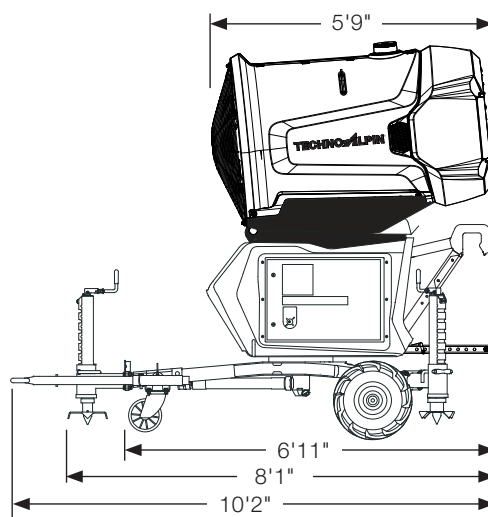
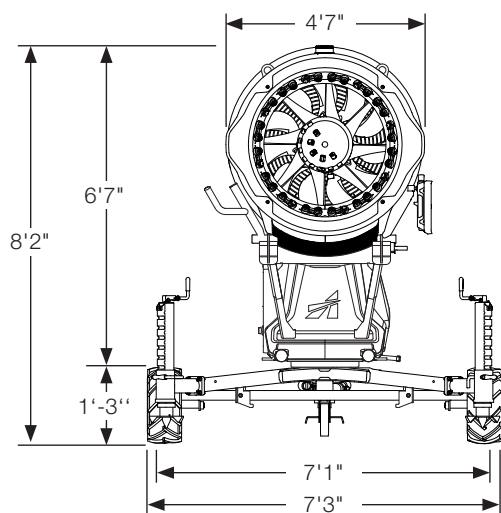

### Electrical characteristics

|                   |         |
|-------------------|---------|
| Rated voltage     | 400 V   |
| Full load current | 50 Hz   |
| Largest motor     | 35 A*   |
| Nominal frequency | 5x63 A  |
| Connection plug   | 18.5 kW |
| Heating           | 1.0 kW  |

### Weights

|  |              |
|--|--------------|
| Snow producer - compressor             | 1437 lb 7 oz |
| Transport frame with jacks             | 264 lb 9 oz  |
| Double lifting hook                    | 83 lb 12 oz  |
| Kit for mobile carriage tow (CTGR0007) | 136 lb 11 oz |
| 100' Cable - electrical power supply   | 66 lb 2 oz   |
| 100' Cable - control                   | 17 lb 10 oz  |
| Total weight [max.]                    | 2182 lb 9 oz |

### Dimensions

|                      |      |
|----------------------|------|
| Snow producer length | 5'9" |
| Snow producer width  | 4'7" |
| Snow producer height | 6'7" |
| Undercarriage height | 1'3" |

|                              |       |
|------------------------------|-------|
| Total height                 | 8'2"  |
| Length [max.]                | 10'2" |
| Length [without steering]    | 8'1"  |
| Length [without front jacks] | 6'11" |
| Track [wheels]               | 7'3"  |
| Width [without wheels]       | 7'1"  |

### Miscellaneous

|                       |              |
|-----------------------|--------------|
| Operating temperature | -13 ÷ +36 °F |
| Number of revolutions | 1,800 rpm    |
| Turbine inclination   | 45 deg.      |
| Horizontal rotation   | 360 deg.     |
| Swinging (automatic)  | 180 deg.     |

### Water

|                            |               |
|----------------------------|---------------|
| Operating water pressure   | 116 ÷ 580 psi |
| Water filter               | 250 micron    |
| Water connection - Camlock | 2"            |

### Nozzle configuration

|                                       |    |
|---------------------------------------|----|
| Nucleator                             | 6  |
| Fixed nozzles - quadrijet type        | 6  |
| Controllable nozzles - quadrijet type | 12 |

\*Data collected at 820 ft (250 m) above the sea level and 68 °F (20 °C).

Data are subject to change depending on system type and/or country of installation.



[WWW.TECHNOALPIN.COM](http://WWW.TECHNOALPIN.COM)